



## THE CENTREPIECE

### CLYDE'S FRESH NEW MASTERPLANNED COMMUNITY

The Centrepiece will be Eliston's most sought after location and includes premium 18 lots set amongst the estate's largest parkland, offering a plethora of sport and recreational activities. Just a short walk to the State Primary School and Community Centre, lots sizes range from 294m<sup>2</sup> to 643m<sup>2</sup>, so purchasers can select the right sized lot to build their dream home in a fantastic location. Now is your chance to call Eliston home and see why it really is the land of plenty.

For more information on The Centrepiece Release at Eliston, visit our Discovery Centre:  
20 Pattersons Road, Clyde  
Open 7 days from 11am - 5pm

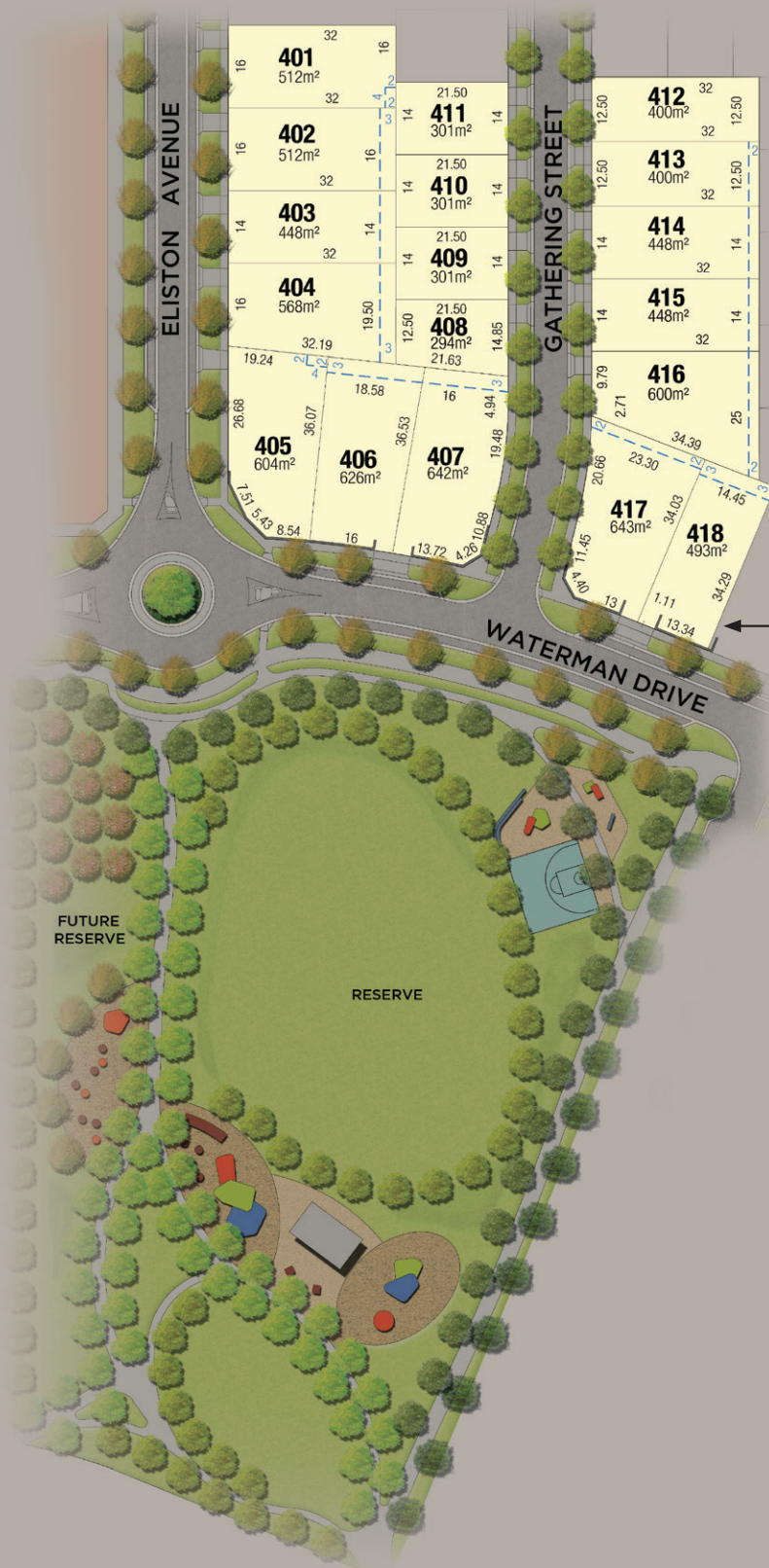

## MASTERPLAN

All photos and illustrations are representative and should be used as a guide only. This information is subject to change without prior notice, and while every reasonable effort is made to ensure current and accurate information is presented, National Pacific Properties Twyford Road Pty Ltd makes no guarantee in respect to the final outcome of any kind.